

| 1 | 2 | 3 | 4 | 5 | 6 |
|-----|---------------|--------|-------|------------|---|
| REV | DESCRIPTION | ECN NO | NAME | DATE | |
| 0 | FIRST EDITION | N/A | HRWEI | 2020-04-15 | |

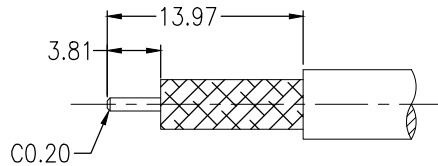

ALL PARTS MUST MEET TO RoHS REQUIREMENTS

REMARK:
 1.CONTACT PIN TO SOLDER
 2.CRIMPED FERRULE HEX. CRIMP SIZE .213"
 3.ADDS SIZE:16.18mm



RECOMMENDED CABLE STRIPPING DIM'S

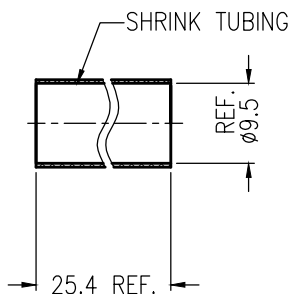
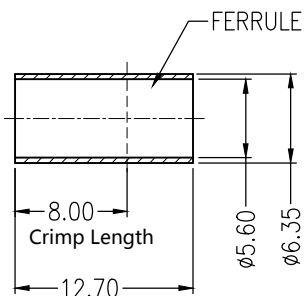
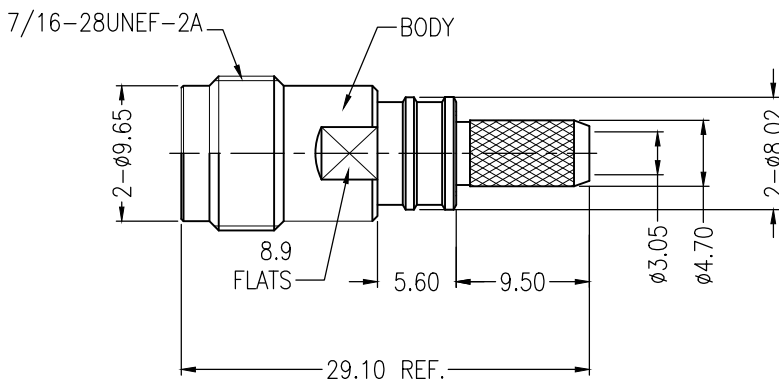
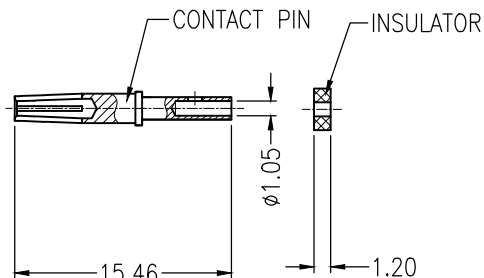

| MATERIALS AND PLATING | | UNIT: MICRO-INCHES |
|-----------------------|------------------|---------------------------|
| BODY/SHELL | BRASS C3604 | ALBALOY 100 u"/COPPER |
| CONTACT PIN | Be-Cu C17300 | GOLD 10 u"/NICKEL /COPPER |
| INSULATOR | PTFE ASTM-D-1710 | N/A |
| FERRULE | BRASS | ALBALOY 100 u"/COPPER |

| ELECTRICAL CHARACTERISTICS | |
|---------------------------------|----------------|
| Impedance | 50 Ω |
| Voltage rating | N/A |
| Frequency range | DC ~ 6 GHz |
| Dielectric withstanding voltage | >750 V |
| Contact resistance | Center contact |
| | Outer contact |
| Insulation resistance | >5000 MΩ |
| Insertion loss | N/A |
| RF- leakage | N/A |
| VSWR | <1.30 |
| 3rd Intermodulation | N/A |

| MECHANICAL CHARACTERISTICS | |
|--------------------------------|-------------|
| Force to engage and disengage | N/A |
| Center contact retention force | N/A |
| Recommended coupling torque | N/A |
| Coupling nut retention force | N/A |
| Durability | >500 cycles |

| ENVIRONMENTAL CHARACTERISTICS | |
|-------------------------------|------------------------------------|
| Temperature range | -40°C ~ +125 °C |
| Thermal shock | US MIL- STD 202, Meth. 107,Cond. B |
| Vibration | US MIL- STD 202, Meth. 204,Cond. B |
| Shock | US MIL- STD 202, Meth. 213,Cond. I |

*CUSTOMER OUTLINE DRAWING

UNLESS OTHERWISE SPECIFIED:
 1) C0.15 MAX;
 2) REMOVE ALL BURRS;
 3) SURFACE ROUGHNESS : Ra1.6;
 4) UNITS:mm;
 5) DIMENSIONS TOLERANCES
 DECIMALS .x ±0.3 .xx ±0.2 .xxx±0.1
 ANGLES ±5°

THIRD ANGLE PROJECTION

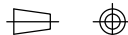

APPROVED:

CUSTOMER P/N:

3190-6782

CHECKED:

SCALE:

2:1

DRAWING:

DATE: 2020-04-15

COMPANY WEBSITE: www.slkcorp.com



TITLE: TNC FEMALE S/T FOR LMR-195 CABLE

DRAWING NO: 5TCF11S-A45-001

CUSTOMER OUTLINE DRAWING